

SOLAR PANEL User manual

AC602-01, AC602-02

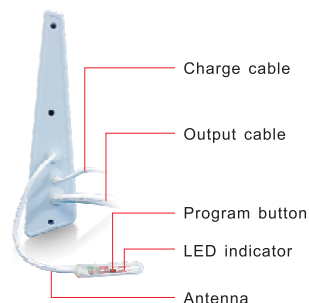

AC602-01 Side



AC602-02 Side

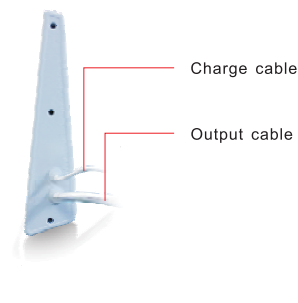

Solar panel can store up the DC power into batteries after converting the luminous energy to electric energy. Solar panel is one the most important part of the solar power supply system, the conversion rate and life of it is te most important elements to evaluate it's use value.

Features

Common function for AC602-01 and AC602-02

- Water-proof design, IP67 level, to protect batteries and control board
- Aluminum alloy frame, anti-hitting
- polycrystalline silicon solar panel with high conversion rate
- It can be chargeable to supply power in rainy day
- 14. 8V/4. 4A/H dynamical type battery group built inside, to support to drive high torque motor
- Specialized brackets for batteries, to achieve a good heat dissipation
- Japanese IC to assure the battery safety

Unique function of AC602-01

- DC motor controller built in with power saving design and world first brand RF chip and control IC
- Under standby situation, the power consumption is as low as 20μA
- With high-power relay, safety and reliable,

Technic data

Model : AC602-01

Name	Solar panel
Power	12W
Circuit voltage	21.6V
Working voltage	18V
Working current	0.67A

Name	Battery group
Standard voltage	14.8V
Standard capacity	4.4A/H
Max. Current	20A

Name	Built in radio receiver
Standby power consumption	20μA
Max. Loading current	20A
RF frequency	433.92MHz

Model : AC602-02

Name	Solar panel
Power	12W
Circuit voltage	21.6V
Working voltage	18V
Working current	0.67A

Name	Battery group
Standard voltage	14.8V
Max. Current	20A

Installation

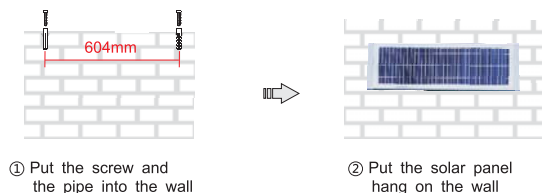

Caution

- Please install the panel in the place with long sunshine to get more electricity
- Please install the panel in the place with safety to avoid hitting and damages by objects
- Please install the panel in the place without high acidity to avoid corrosion

Application

AC602-01 + DC tubular motor DC12V

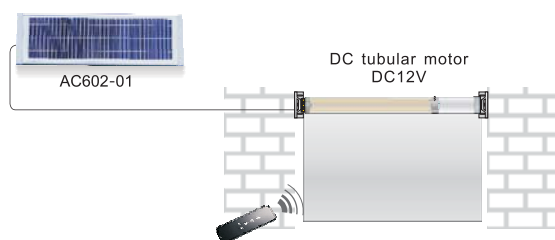

AC602-02 + DC tubular motor DC12V

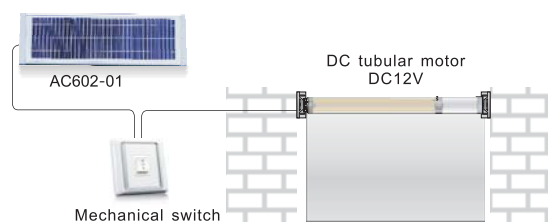

Function setting : *0.5S delay for motor UP/DOWN transfer, single running time is 5 minutes

Below is the function for AC602-01, AC602-02 do not have this function

Programming *It can be programmed with Max. 20 controllers, the 21st will cover the 20th

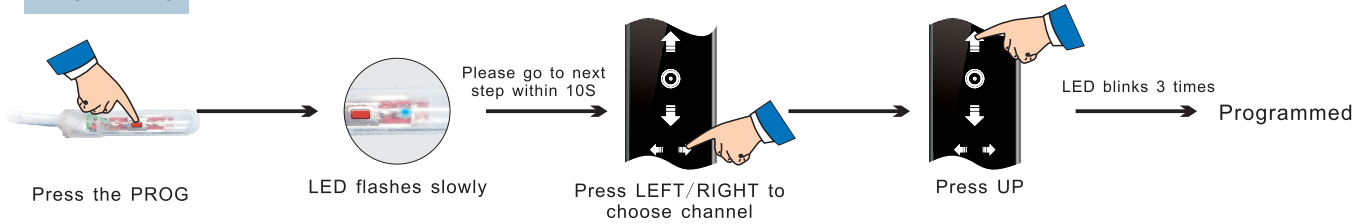

Dot move/continuous move transfer

* under continuous move mode, press: UP, motor moves up, STOP, motor stops, DOWN, motor moves down
* under dot move mode, press: UP/DOWN>1S, motor moves continuously, UP/DOWN≤1S, motor moves step by step

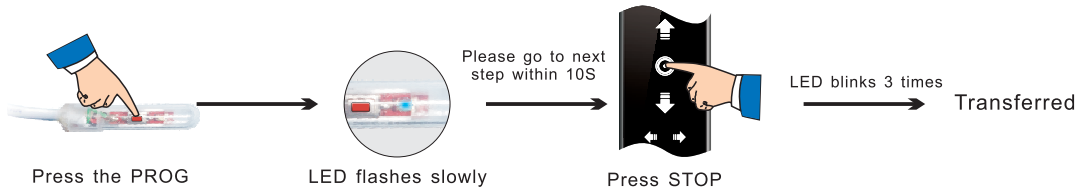

Direction changing

* If needed

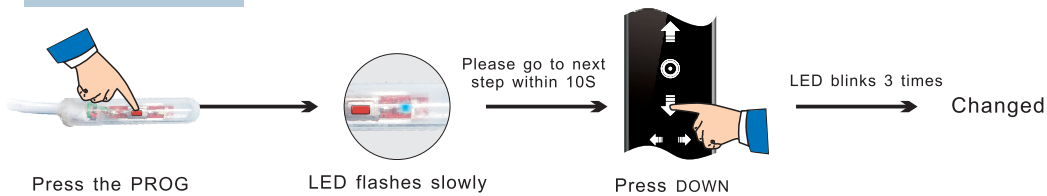

Adding new transmitter

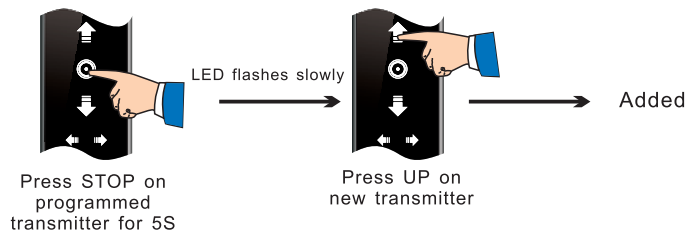

Deleting single channel

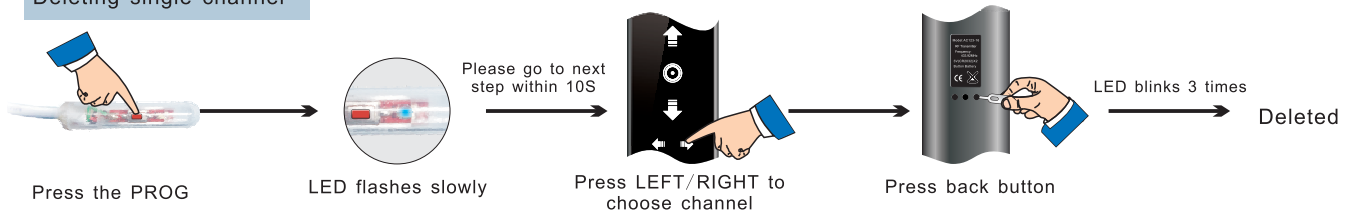

Deleting all channels on transmitter

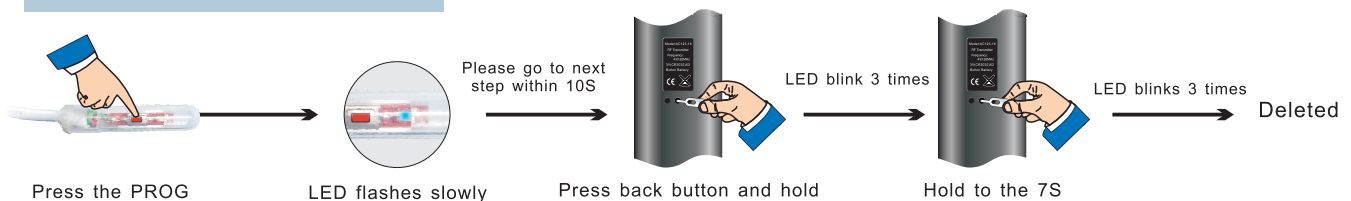

Deleting all channels on receiver

